

WitaTrap® Funnel Trap



box tree moth
(*Cydalima perspectalis*)

Trap especially suited for mass trapping butterflies and beetles

- Install pheromone underneath trap cover (Lid) in holding unit (Cage and Cap).
- Insects (for example moths ore beetles) attracted by the pheromone fall into capture container and cannot fly out (live trap).
- Especially suited for insects like: box tree moth, gipsy moth, nun moth, oak processionary moth, goat moth, leopard moth, winter moth, cockchafer, old house borer, etc. **(suitable pheromones available from Witasek)**
- The Bucket of the WitaTrap® Funnel Trap is available in two colours:
 - green
 - transparent

Instructions for Assembling:

- Place the pheromone/attractant dispenser inside the cage and close them with the cap.
- The loaded und closed holding unit is placed in the hole in the middle of the cover
- Put the cover on the funnel and make sure that the pins on the underside of it exactly match the opposite piece of the funnel
- Push the funnel onto the bucket and twist clockwise to seal the container.
- The trap should be checked regularly (at least two times per week)
- We recommend to replace the pheromon (attractant dispenser) every four weeks to obtain optimal catch results
- **Tipp:** you can add a little salty solution (2-4 cm) to the attractant container to prevent insects from escaping.

(See back for more information on assembly)

item no.	item
313911	WitaTrap® Funnel Trap
	Sales unit: from 1 piece



Matching pheromones available at Witasek! – www.witasek.com



witasek®

witasek PflanzenSchutz GmbH

Witasek-Allee 2 • 9560 Feldkirchen

Tel.: +43(0)4276 / 3230 • Fax: +43(0)4276 / 2088-399

office@witasek.com • www.witasek.com

Assembly instructions – WitaTrap® Funnel Trap

Components

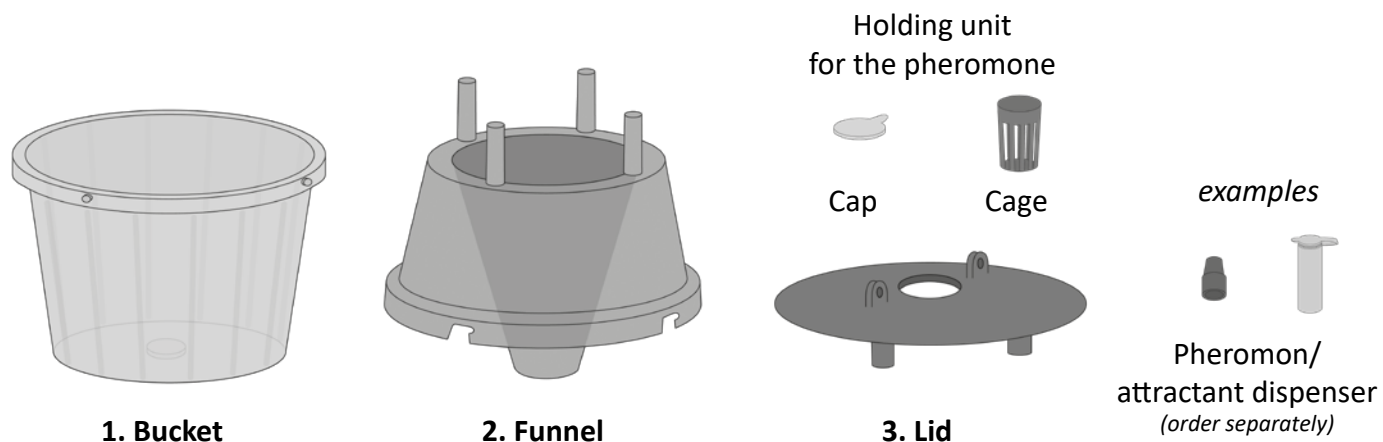

Assembling

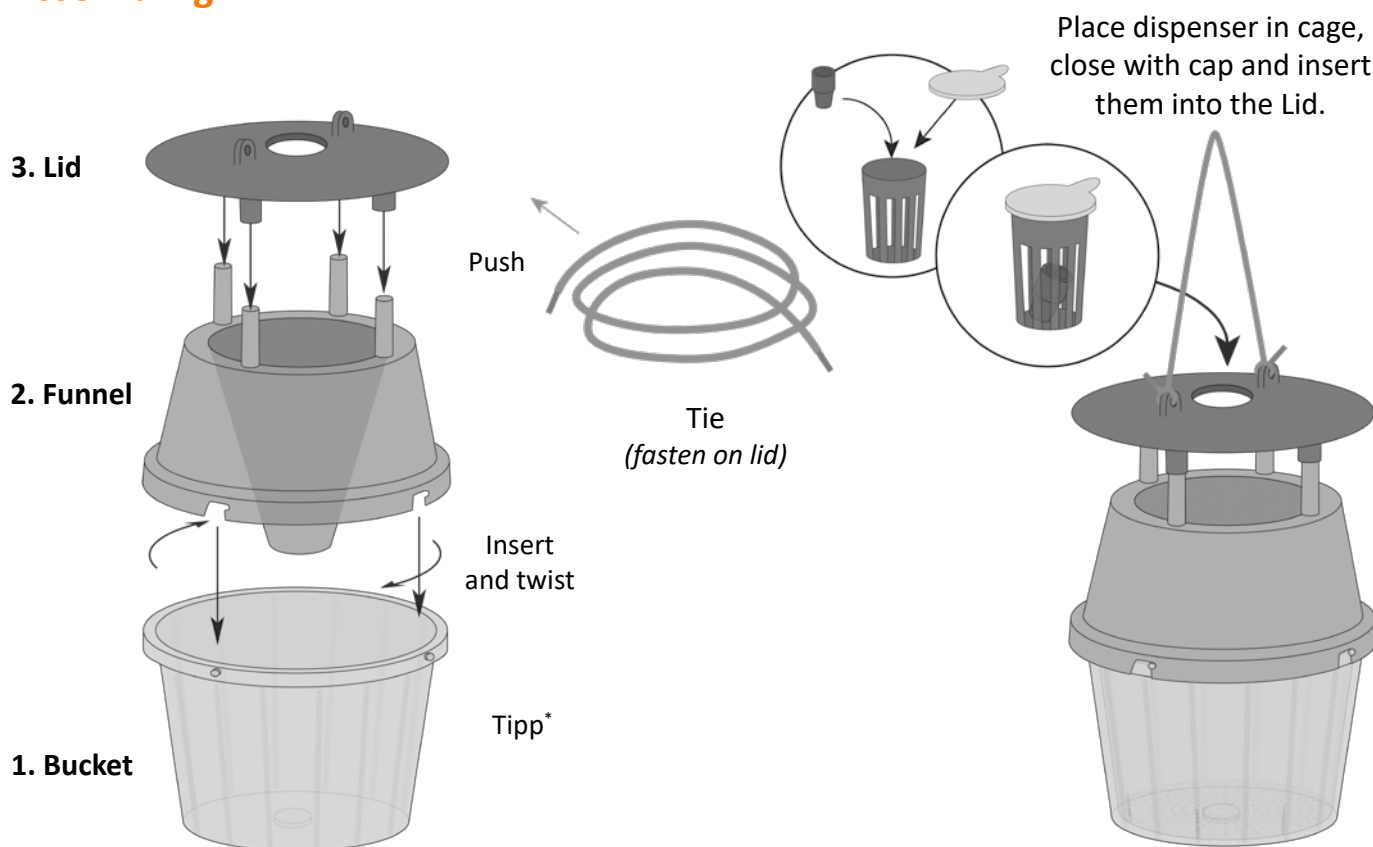

*Tipp: You can fill some water (2–4 cm) with salt into the bucket to prevent insects from escaping.